

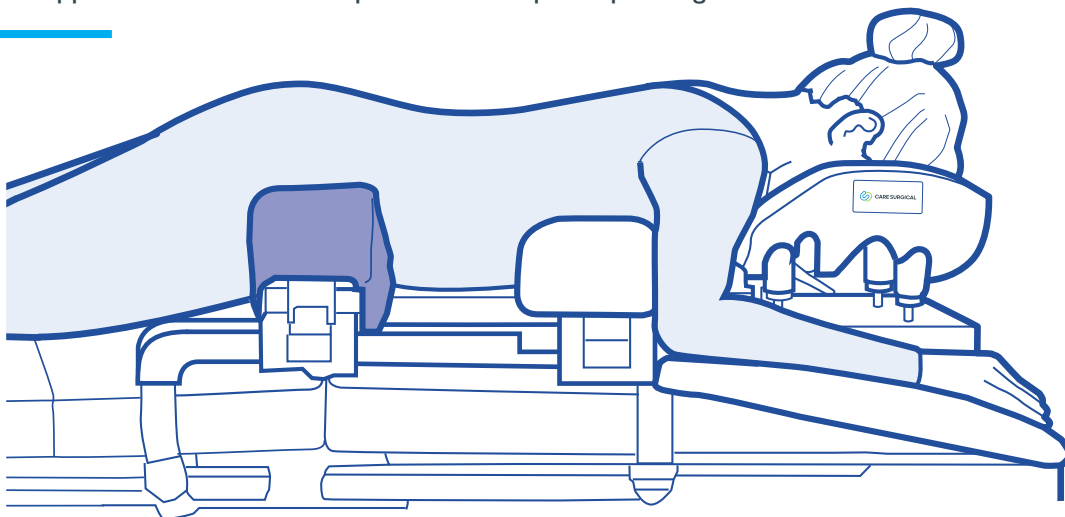

# CARE SURGICAL CS Hip Supports Small (pair)

Patient Supports for use on the CS Spine Frame or spinal operating tables



Refer to the label on the support to ensure it is placed in the correct position on the table.



Manufacturer

UK: Care Surgical Ltd  
Unit 6 Ringtail Road  
Burscough, L40 8JY  
Tel: 01704 336671

USA: Care Surgical LLC  
43 Broad Street  
Suite B106, Hudson,  
MA 01749, USA  
Tel: 866-243-4107

[www.care-surgical.com](http://www.care-surgical.com)

EC REP

Care Surgical Supplies Limited, Office 2, 12a Lower Main Street,  
Lucan Co. Dublin, K78 X5P8 Ireland



5 060624 120626



LOT:



Medical Device



Reuse



Latex Free



Non Sterile



UK Conformity  
Assessed



CE Mark



Maximum  
Weight

Product Code: CSM-2723 Rev. 3 02/24

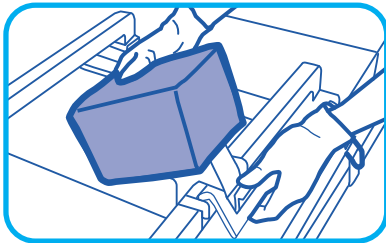

- 1** Place the supports on the frame so that the brackets are over the bars

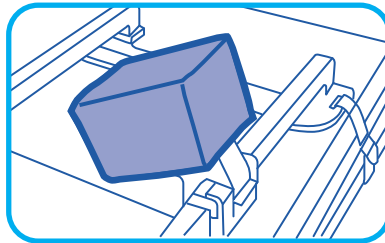

- 2** Snap the locking clip shut to secure the support in position

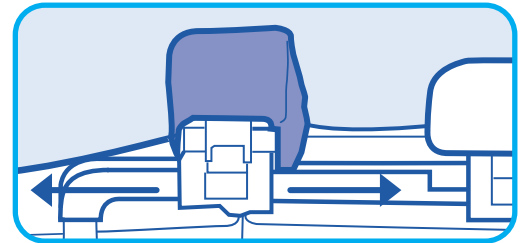

- 3** To adjust the position of the supports, release the clip(s), raise the patient's chest or hips, slide the supports to the correct position, lock the clip(s)

Ensure the iliac crest is in the centre of the hip pads.

These products will support a patient weight of up to 250kg. Do not exceed the weight capacity of the operating table.

## Cleaning instructions:

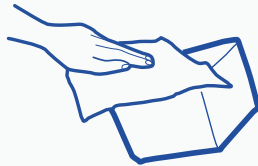

Clean using standard hospital wipes



Do not immerse in water



Do not autoclave



Manufacturer

UK: Care Surgical Ltd  
Unit 6 Ringtail Road  
Burscough, L40 8JY  
Tel: 01704 336671

USA: Care Surgical LLC  
43 Broad Street  
Suite B106, Hudson,  
MA 01749, USA  
Tel: 866-243-4107

[www.care-surgical.com](http://www.care-surgical.com)



Care Surgical Supplies Limited, Office 2, 12a Lower Main Street,  
Lucan Co. Dublin, K78 X5P8 Ireland



Medical Device



Reuse



Latex Free



Non Sterile



UK Conformity  
Assessed



CE Mark



Maximum  
Weight