

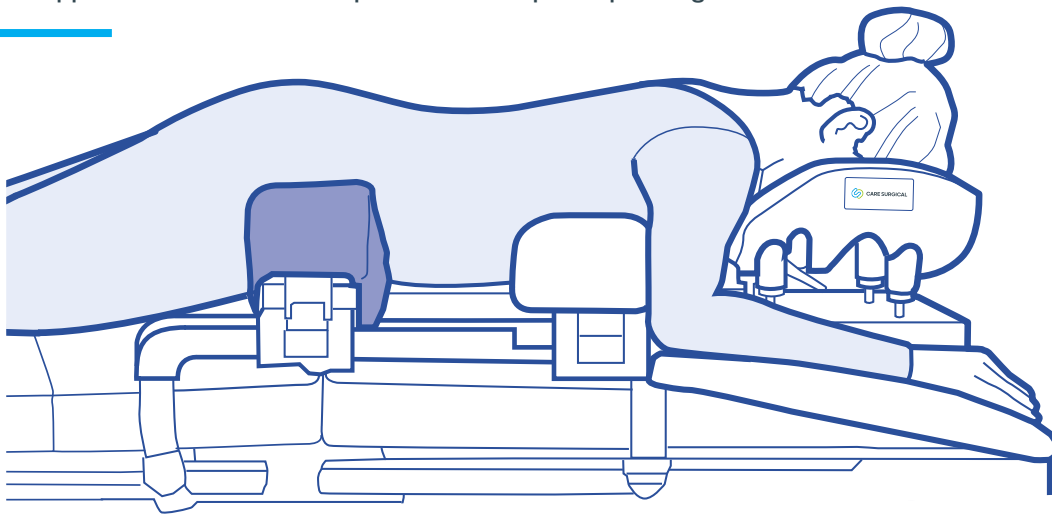

CARE SURGICAL

CS Hip Supports Large (pair)

Patient Supports for use on the CS Spine Frame or spinal operating tables



Refer to the label on the support to ensure it is placed in the correct position on the table.



Manufacturer

UK: Care Surgical Ltd
Unit 6 Ringtail Road
Burscough, L40 8JY
Tel: 01704 336671

USA: Care Surgical LLC
Marlborough
MA 01752
Tel: 866-243-4107

www.care-surgical.com

Care Surgical Supplies Limited, 69 Esker Woods Drive
Lucan, Co Dublin, K78PX45, Ireland



5 060624 120640



Medical Device



Reuse



Latex Free



Non Sterile



UK Conformity Assessed



CE Mark



Maximum Weight

Product Code: CSM-2719

Australian Sponsor, Summit Surgical
PO Box 60, Landsborough
QLD 4550 Australia

LOT Number:



Product Code: CSM-2719 Rev 06 06/21

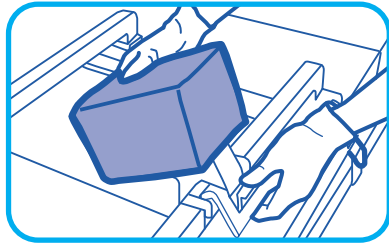

1 Place the supports on the frame so that the brackets are over the bars

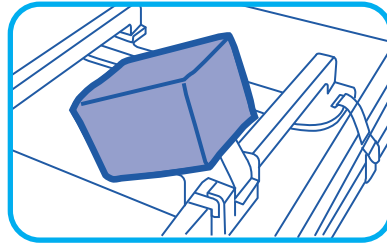

2 Snap the locking clip shut to secure the support in position

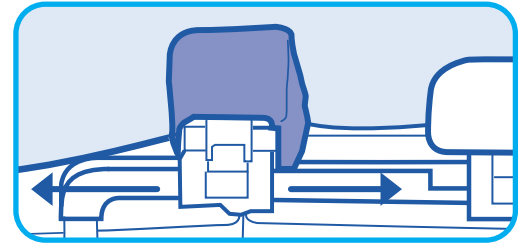

3 To adjust the position of the supports, release the clip(s), raise the patient's chest or hips, slide the supports to the correct position, lock the clip(s)

Ensure the iliac crest is in the centre of the hip pads.

These products will support a patient weight of up to 250kg. Do not exceed the weight capacity of the operating table.

Cleaning instructions:



Clean using standard hospital wipes



Do not immerse in water



Do not autoclave



Manufacturer

UK: Care Surgical Ltd
Unit 6 Ringtail Road
Burscough, L40 8JY
Tel: 01704 336671

USA: Care Surgical LLC
Marlborough
MA 01752
Tel: 866-243-4107



Medical Device



Reuse



Latex Free



Non Sterile



UK Conformity Assessed



CE Mark



Maximum Weight

www.care-surgical.com

Care Surgical Supplies Limited, 69 Esker Woods Drive
Lucan, Co Dublin, K78PX45, Ireland



Australian Sponsor, Summit Surgical
PO Box 60, Landsborough
QLD 4550 Australia



Product Code: CSM-2719 Rev 06 06/21

GTIN

- + 5060624120633

Description

- + See CSM2720

Intended use

- + See CSM2720

Indications for Use

- + See CSM2720

Warnings, Precautions, Contraindications & Adverse Effects

- + See CSM2720

Packaging

- + Each Unit is packaged in a recyclable polyethene bag
- + 1 pair is packaged into a cardboard box for sale

Transport & Storage

- + Transport and store in dry conditions and out of direct light where possible
- + Avoid storing where sharp objects could pierce the skin of the product