

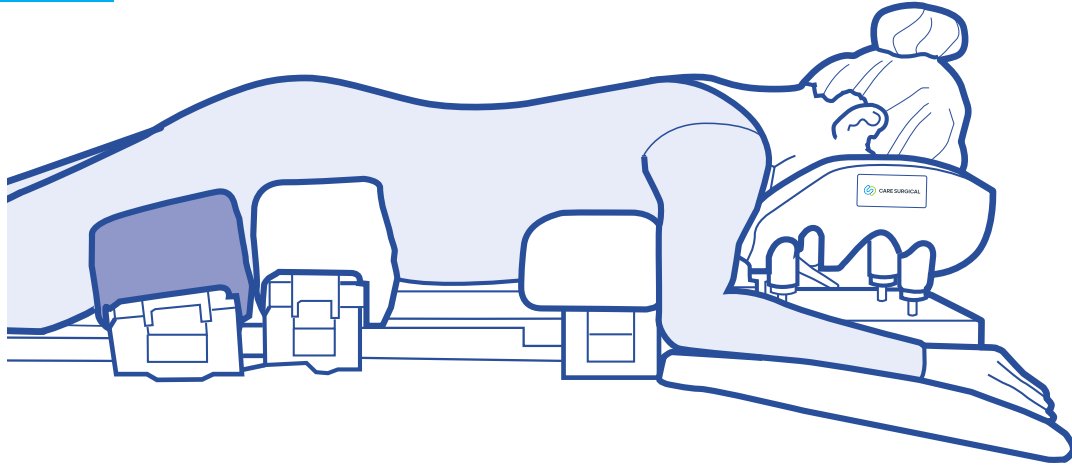

# CARE SURGICAL

# CS Thigh Supports (pair)

Patient Supports for use on the CS Spine Frame or spinal operating tables



Refer to the label on the support to ensure it is placed in the correct position on the table.



Manufacturer

UK: Care Surgical Ltd  
Unit 6 Ringtail Road  
Burscough, L40 8JY  
Tel: 01704 336671

USA: Care Surgical LLC  
Marlborough  
MA 01752  
Tel: 866-243-4107

[www.care-surgical.com](http://www.care-surgical.com)

Care Surgical Supplies Limited, 69 Esker Woods Drive  
Lucan, Co Dublin, K78PX45, Ireland



Medical Device



Reuse



Latex Free



Non Sterile



UK Conformity Assessed



CE Mark



Maximum Weight

Australian Sponsor, Summit Surgical  
PO Box 60, Landsborough  
QLD 4550 Australia

LOT Number:



Product Code: CSM-2718 Rev 05 06/21

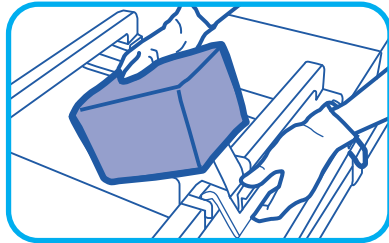

**1** Place the supports on the frame so that the brackets are over the bars

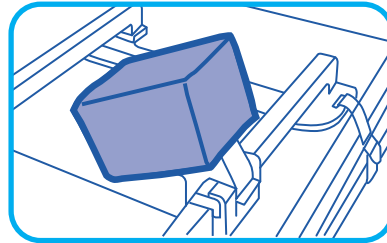

**2** Snap the locking clip shut to secure the support in position

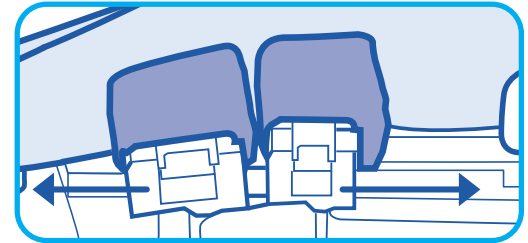

**3** To adjust the position of the supports, release the clip(s), raise the patient's chest or hips, slide the supports to the correct position, lock the clip(s)

Ensure the iliac crest is in the centre of the hip pads.

These products will support a patient weight of up to 250kg. Do not exceed the weight capacity of the operating table.

### Cleaning instructions:



Clean using standard hospital wipes



Do not immerse in water



Do not autoclave



Manufacturer

UK: Care Surgical Ltd  
Unit 6 Ringtail Road  
Burscough, L40 8JY  
Tel: 01704 336671

USA: Care Surgical LLC  
Marlborough  
MA 01752  
Tel: 866-243-4107



Medical Device



Reuse



Latex Free



Non Sterile



UK Conformity Assessed



CE Mark



Maximum Weight

[www.care-surgical.com](http://www.care-surgical.com)

Care Surgical Supplies Limited, 69 Esker Woods Drive  
Lucan, Co Dublin, K78PX45, Ireland



Australian Sponsor, Summit Surgical  
PO Box 60, Landsborough  
QLD 4550 Australia



Product Code: CSM-2718 Rev 05 06/21

## GTIN

- + 5060624120794

## Description

- + Thigh supports made from polyurethane foam with a wipeable fabric covering

## Intended use

- + Supports the patient's thighs in the prone position

## Indications for Use

- + Attach to the CS Spine Frame or other suitable modular operating frame or table to support the patient's thighs whilst in the prone position
- + Use the incorporated clips to attach the support to the table
- + Open the clip to slide the support laterally into the required position
- + Close the clip securely to ensure the support does not move during the procedure
- + Reusable: Clean using non-alcohol hospital wipes
- + Number of uses: Unrestricted, subject to damage (see damage indicators in the Contraindications column)
- + Instructions for use are packaged with the product

## Warnings, Precautions, Contraindications & Adverse Effects

- + If the clips are not fully closed, the support could move during the procedure which could cause injury to the patient or clinician
- + Incorrect positioning of the patient on this product could result in the patient experiencing:
  - + Pressure ulcers
  - + Neurological damage, which can lead to temporary or permanent paralysis
  - + Venous pressure, which can lead to ischaemia
- + Examine the product for damage before and after each use. If the skin is pierced or torn, it cannot be cleaned effectively and should be replaced
- + Do not immerse in water
- + Do not autoclave

## Packaging

- + Each Unit is packaged in a recyclable polyethene bag
- + 1 pair is packaged into a cardboard box for sale

## Transport & Storage

- + Transport and store in dry conditions and out of direct light where possible
- + Avoid storing where sharp objects could pierce the skin of the product