

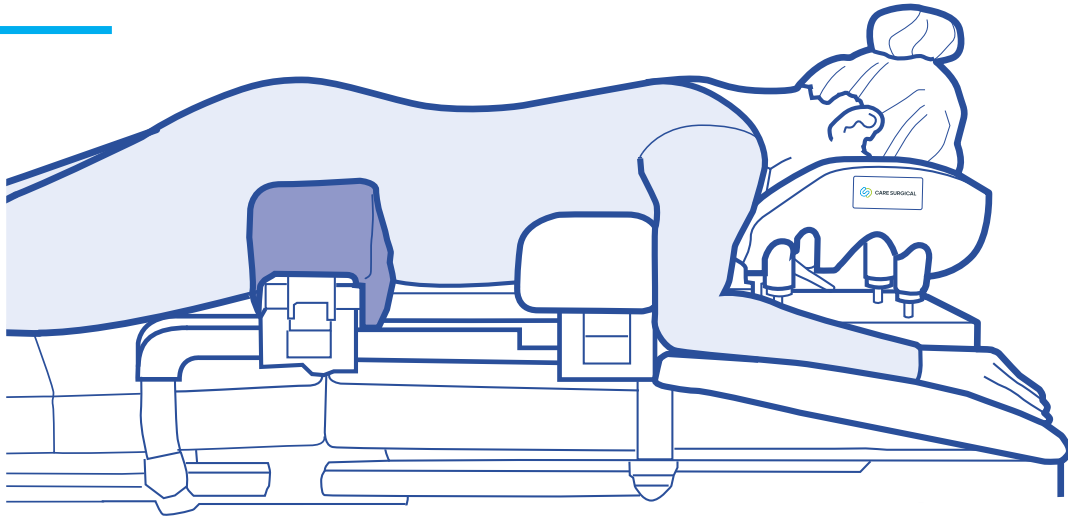

CARE SURGICAL

CS Hip Supports (pair)

Patient Supports for use on the CS Spine Frame or spinal operating tables



Refer to the label on the support to ensure it is placed in the correct position on the table.



Manufacturer

UK: Care Surgical Ltd
Unit 6 Ringtail Road
Burscough, L40 8JY
Tel: 01704 336671

USA: Care Surgical LLC
Marlborough
MA 01752
Tel: 866-243-4107

www.care-surgical.com

Care Surgical Supplies Limited, Office 2, 12a Lower Main Street,
Lucan Co. Dublin, K78 X5P8 Ireland

EC REP



5 060624 120657



Medical Device



Reuse



Latex Free



Non Sterile



UK Conformity Assessed



CE Mark



Maximum Weight

Australian Sponsor, Summit Surgical
PO Box 60, Landsborough
QLD 4550 Australia

LOT:

Product Code: CSM-2717 Rev.7 10/23

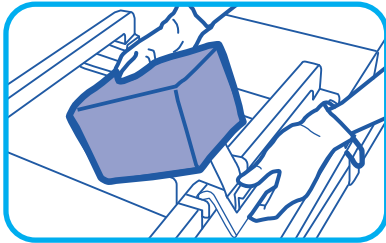

1 Place the supports on the frame so that the brackets are over the bars

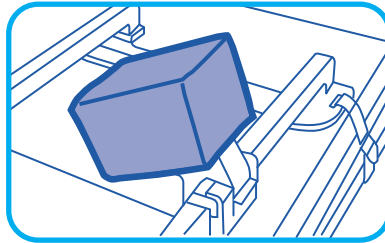

2 Snap the locking clip shut to secure the support in position

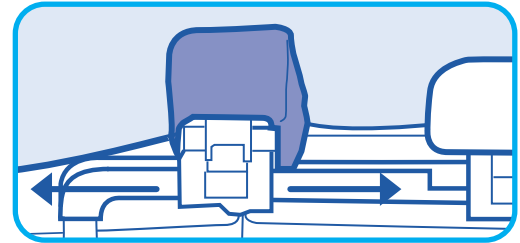

3 To adjust the position of the supports, release the clip(s), raise the patient's chest or hips, slide the supports to the correct position, lock the clip(s)

Ensure the iliac crest is in the centre of the hip pads.

These products will support a patient weight of up to 250kg. Do not exceed the weight capacity of the operating table.

Cleaning instructions:

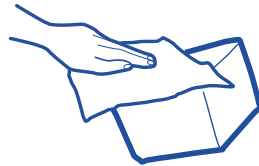

Clean using standard hospital wipes



Do not immerse in water

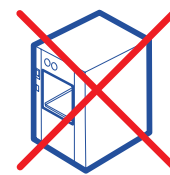

Do not autoclave



Manufacturer

UK: Care Surgical Ltd
Unit 6 Ringtail Road
Burscough, L40 8JY
Tel: 01704 336671

USA: Care Surgical LLC
Marlborough
MA 01752
Tel: 866-243-4107



Medical Device



Reuse



Latex Free



Non Sterile



UK Conformity Assessed



CE Mark



Maximum Weight

www.care-surgical.com

Care Surgical Supplies Limited, Office 2, 12a Lower Main Street,
Lucan Co. Dublin, K78 X5P8 Ireland

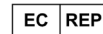

Australian Sponsor, Summit Surgical
PO Box 60, Landsborough
QLD 4550 Australia

Product Code: CSM-2717 Rev.7 10/23